



INSTALLATION INSTRUCTIONS

MSD Launch Control PN 8735

IMPORTANT: Read these instructions completely before attempting the installation.

Parts Included:

- 1 - Launch Control
- 4 - Mounting Screws

WARNING: During installation, disconnect the battery cables. When disconnecting the battery, always remove the Negative cable first and install it last.

The MSD Launch Control allows you to select three different rpm limits. Two limits, the race and burnout, are adjusted with plug-in modules. The launch (or holeshot) limit is adjusted with the two rotary switches (Figure 1). The launch and burnout limits are activated when 12 volts are supplied to their corresponding activation wires. When neither limit is activated, the overrev limit is active.

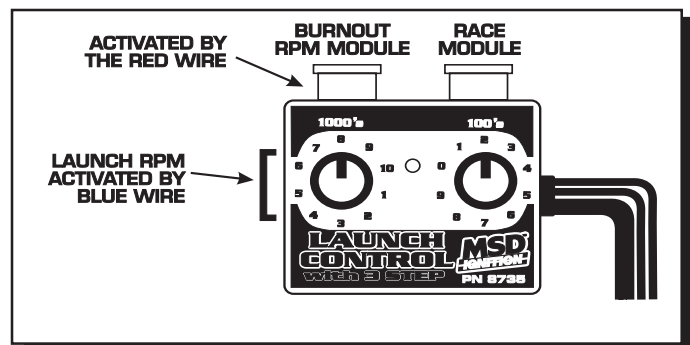

Figure 1 Module Controls and Adjustments.

It is recommended to mount the Launch Control within easy reach of the driver so last minute adjustments can be made to the launch rpm setting. Also, make sure the wiring reaches the MSD Ignition. Mark the location of the mounting holes, then drill the holes using an 1/8" bit. Use the supplied mounting screws to secure the Control.

WIRE FUNCTIONS

Activation Wires

- Blue** Launch Module Activation Wire. When 12 volts are applied, the launch circuit is activated. **Note:** This circuit overrides the other modules.
- Red** Burnout Activation Wire. When 12 volts are applied, this module (Burnout) is activated.

2-Pin Module Harness

- Bare wire** Connect to Ground on the MSD Ignition.
- Red** Connects to Switched 12 volts, such as the IGN terminal on MSD 7 Series.
- 2-Pin** This connector plugs into the rpm module socket of an MSD Ignition or Rev Control. **Note:** The Control will only operate when this is installed one way. It is correct when the LED on the Control lights when the ignition is turned On. If the LED does not come on, turn the 2-Pin connector around and try again.

MSD IGNITION™ INSTALLATION INSTRUCTIONS

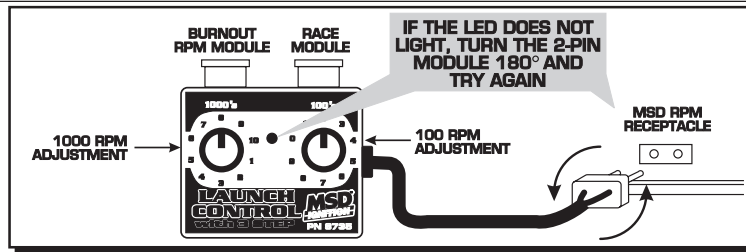

Figure 2 Connecting the 2-Pin Connector.

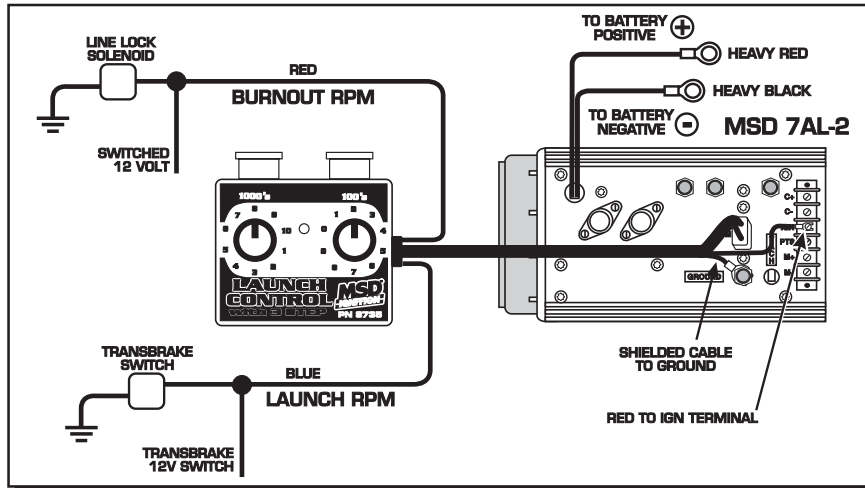

Figure 3 Wiring with an MSD 7 Series Ignition.

Service

In case of malfunction, this MSD component will be repaired free of charge according to the terms of the warranty. When returning MSD components for service, Proof of Purchase must be supplied for warranty verification. After the warranty period has expired, repair service is charged based on a minimum and maximum charge.

Send the unit prepaid with proof of purchase to the attention of: **Customer Service Department, Autotronic Controls Corporation, 12120 Esther Lama, Suite 114, El Paso, Texas 79936.**

When returning the unit for repair, leave all wires at the length in which you have them installed. Be sure to include a detailed account of any problems experienced, and what components and accessories are installed on the vehicle.

The repaired unit will be returned as soon as possible after receipt, COD for any charges. (Ground shipping is covered by warranty). All units are returned regular UPS unless otherwise noted. For more information, call the MSD Customer Service Line (915) 855-7123. MSD technicians are available from 8:00 a.m. to 5:00 p.m. Monday - Friday (Mountain Time).

Limited Warranty

Autotronic Controls Corporation warrants MSD Ignition products to be free from defects in material and workmanship under normal use and if properly installed for a period of one year from date of purchase. If found to be defective as mentioned above, it will be replaced or repaired if returned prepaid along with proof of date of purchase. This shall constitute the sole remedy of the purchaser and the sole liability of Autotronic Controls Corporation. To the extent permitted by law, the foregoing is exclusive and in lieu of all other warranties or representations whether expressed or implied, including any implied warranty of merchantability or fitness. In no event shall Autotronic Controls Corporation be liable for special or consequential damages.